



PolinGroup

World's Leading
Single Source Supplier

What Sets Us Apart



Experience & Expertise



Commitment to Quality



Strong Supplier Network



Worldwide References



Excellent Staff



Easy Communication



Strong Partner Network



Competitive Price



High Capacity Plants



Dedicated Customer Service



Know – How



Strong R&D Focus



Geographical Location & Culture



Single Source & Infinite Solution



World's Leading Single Source Supplier



Polin Group is a global group company offering industry leading amusement products and services as a composites supplier, amusement supplier and operator providing integrated solutions to its customers through different brands in the group structure.

We aim to increase growth, efficiency, and scope of activity by always meeting the expectations of businesses and offering the best products and services in the industry. The expertise we have gained over the years in the use of composite materials in various areas has been reflected in our experiences with all areas of the amusement industry, paving the way for us to provide full service in operating both small and large-scale facilities and making us the single source supplier for unlimited, best possible solutions.

Strategic Approach

To maintain our role as the leading single source supplier within the industries we operate, we design, produce and manage new generation, high-impact, value-added, differentiated projects and experiences using a globalization approach.

Milestones

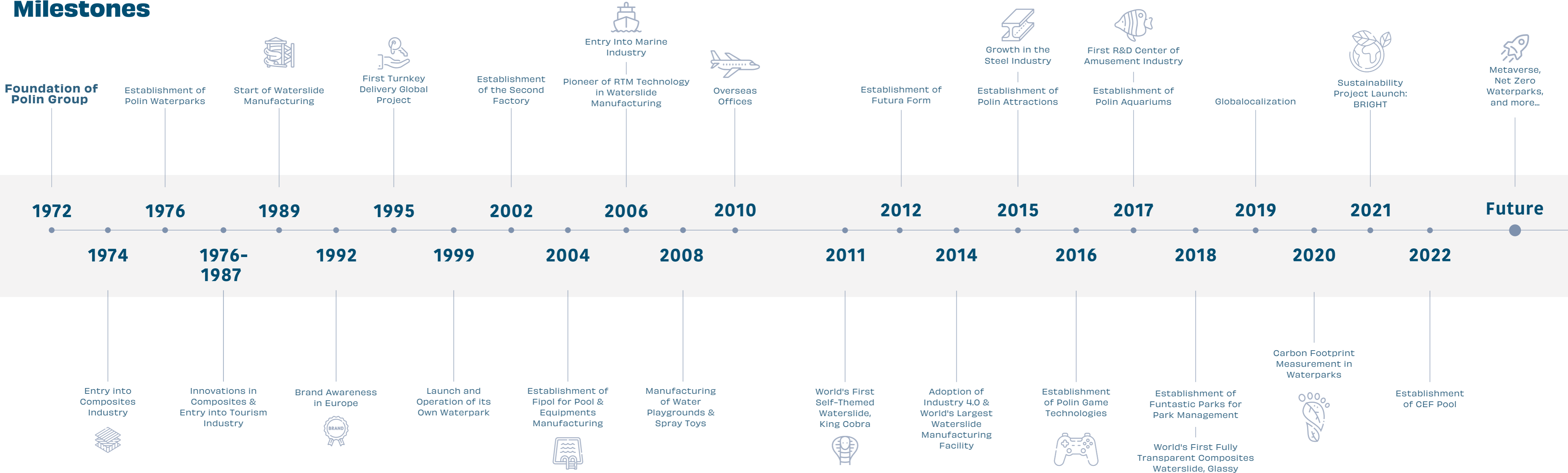

Global Localization

Zone Structuring

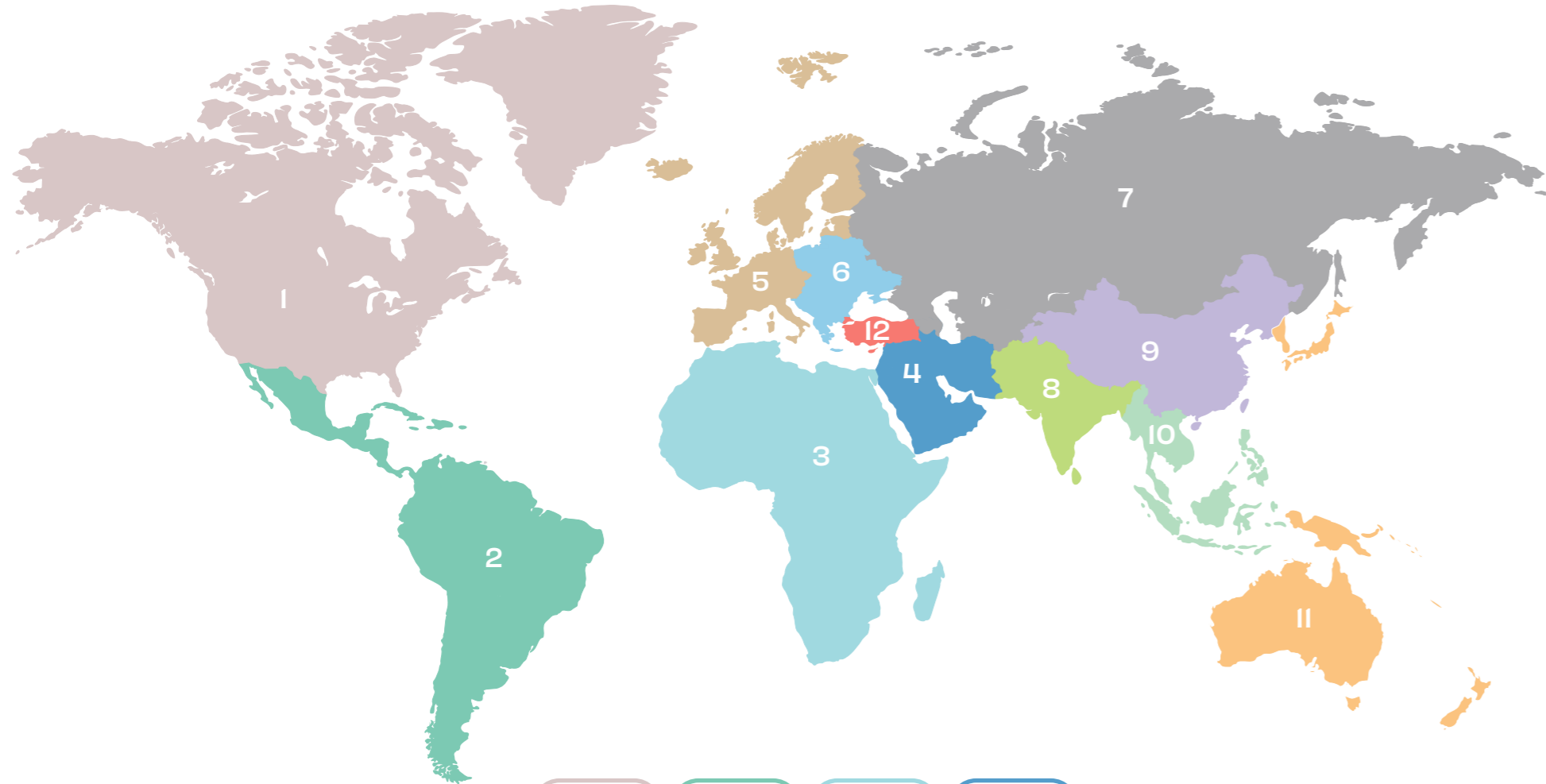

- Zone 1 North America
- Zone 2 South America
- Zone 3 Africa
- Zone 4 Middle East
- Zone 5 Western Europe
- Zone 6 Eastern Europe
- Zone 7 CIS
- Zone 8 South Asia
- Zone 9 China
- Zone 10 South East Asia
- Zone 11 East Asia/Pacific
- Zone 12 Turkey

Facts & Figures

+4.000
Projects in
120
Countries

65
Partners and
Distributors
Worldwide

Founded in
Istanbul, Turkey
1972

52
Years of
Experience

Provides
Franchise
Opportunities

22
Offices
Worldwide

Sets and
Exceed
Industry's
High
Standards
Globally

Full Services
from Design
and Production to
Park Operation

Serves
World-Class
Companies

+180
Prestigious Awards

Signature
Supplier to the
World's Leading
Amusement
Parks Chains

SINGLE SOURCE
COMPOSITES SUPPLIER

SINGLE SOURCE
AMUSEMENT SUPPLIER

SINGLE SOURCE
OPERATOR

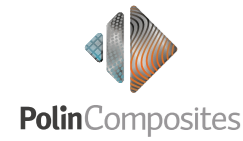

Social Responsibility

As Polin Group, we are aware that social responsibility projects that contribute to the well-being of the world we live in and to the peace of society are very important. For this reason, we closely follow the evolving needs of the world and work meticulously to ensure that everything we do will benefit society.

We set goals related to the environment, human rights, health, education and other social responsibility issues and run campaigns directed at these areas. We know the importance of entertainment and value contributing to securing a livable world while providing this entertainment.

Sustainability

The Future is Green
So are we!

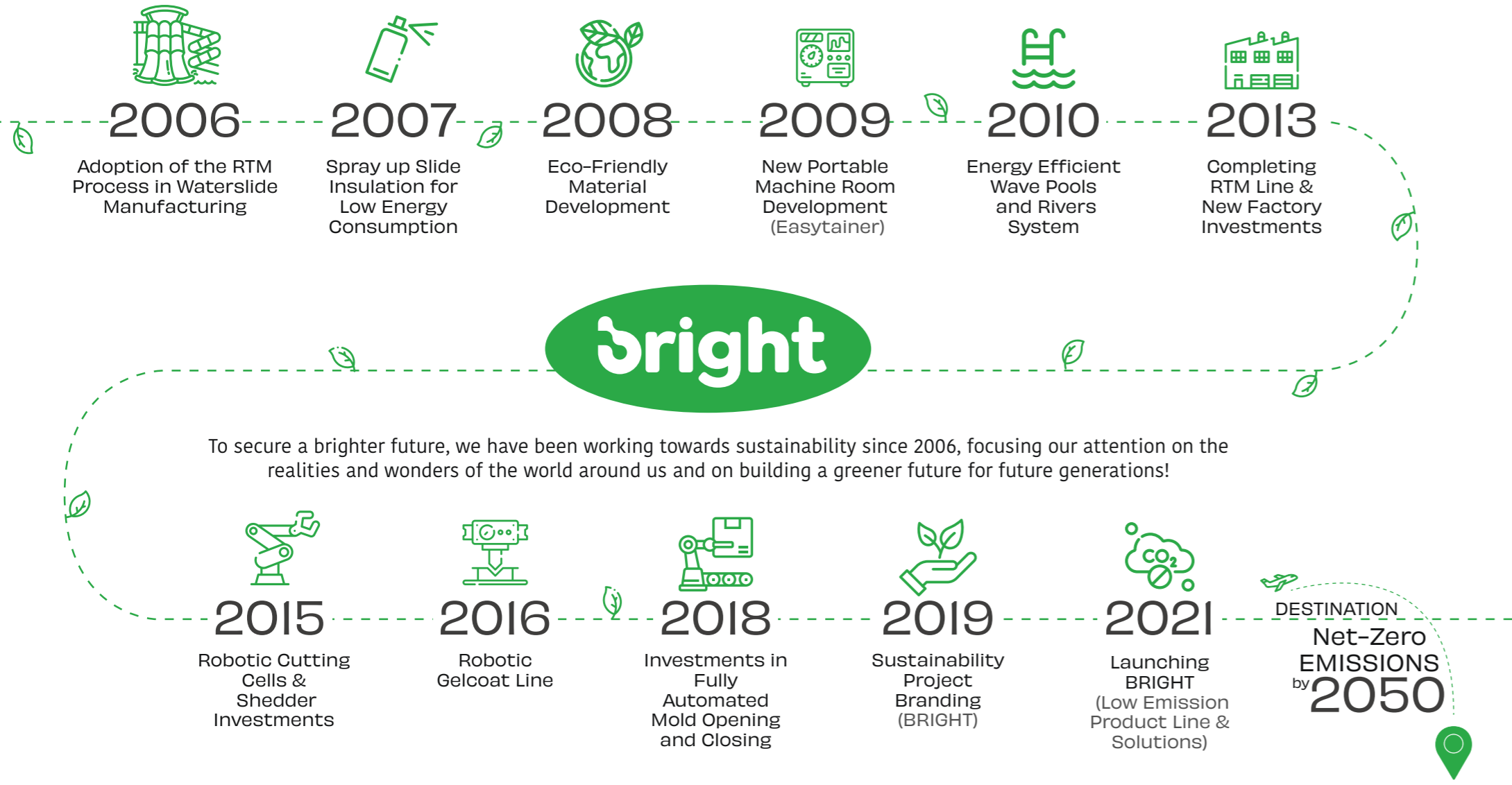

To secure a brighter future, we have been working towards sustainability since 2006, focusing our attention on the realities and wonders of the world around us and on building a greener future for future generations!

Leading the Way to Sustainable Entertainment

With innovative solutions in engineering, energy and water intelligence, and net-zero consultancy, we are dedicated to creating carbon-free entertainment parks. Our commitment to a sustainable future is unwavering.

Sliding into the Greener Future

- **75%** reduction in styrene emissions by using the **L-RTM** process in waterslide manufacturing.
- We maximize the benefits of our renewable energy source with **Natural Light Effects**.
- We use **energy-efficient wave pools and river systems**.
- Prevent water loss by **90%** splashing "**riser**" and reduce water, chemical, and energy consumption "run-out" alternative.
- Our latest slides feature **precision sensors and automation**, achieving up to **60%** energy savings, while insulated outdoor tube slides reduce energy loss by **90%**.
- We offer eco-friendly slides made from **recyclable thermoplastic resin** and **thermoset resin** containing **48%** waste PET, emphasizing the importance of plastic recovery and valorization.
- **U-Texture** technology reduces chemical usage and waste; additionally, we recommend using **reflective colors** to combat global warming."
- The **water control system** saves up to **70%** of energy by adjusting flow rates, while the **tracking system** optimizes energy and water consumption.
- **Regenerative filtration systems** reduce water waste by up to **90%**, cut energy consumption by **50%**, and reduce chemical usage by **30%**.



Our Global Partners

| | | | | | | | | | | | |
|--|--|--|--|--|--|--|--|--|--|--|--|
| | | | | | | | | | | | |
| | | | | | | | | | | | |
| | | | | | | | | | | | |
| | | | | | | | | | | | |
| | | | | | | | | | | | |
| | | | | | | | | | | | |
| | | | | | | | | | | | |



Trusted by Leaders



"We believe that what makes Polin Group unique is the products themselves, as they are well designed and manufactured at the highest standards. Polin Group products have been installed in various waterparks, amusement parks & family entertainment centers and have been enjoyed by people around the world. Their designs are outstanding compared to other rides manufacturers. They are able to adapt to the customer's requirements. We will recommend Polin Group to other entrepreneurs and also share the experience we had working with Polin Group."

Konghart Tantichirasakul
Deputy Managing Director, Santorini Water Fantasy, Thailand



"Our motivation to work with Polin Group was the reputation they have for offering excellent priced and superior quality products. In addition, the outstanding technical team they have for the development of new products, the consistent leading position they have maintained in the industry, and their ability to meet deadlines were decisive factors in entrusting the development of our projects to this company. All the teams we worked with were always readily available and had the technical expertise to meet the needs we had in the development of our equipment. During the assembly work of the equipment, their availability and commitment always remained steadfast, even when minor setbacks arose."

Paulo Jorge Martins Santinha
Director, Slide & Splash, Portugal



"To get inspiration for the project, we visited countless theme parks and waterparks in Europe and elsewhere before finally selecting Polin Waterparks to equip our undercover water paradise after a long tender process that involved many top manufacturers from around the world. Polin made a strong impression during the process. They convinced us that the attractions we would be getting from them offered the best combination of quality, safety, and price."

Peter Dudolenski
Global City Holdings, Park of Poland



"It was a great pleasure to work with Polin Group. Their products are the best and gave us great added value. We worked with Polin Group for many of the parks that belong to our company. We recommend them to others and are excited to see the many new and amazing attractions that are sure to come from Polin Group."

Albert Olivet
Park Manager, Aspro Parks, Spain

The Leading Single Source Supplier



PolinGroup

Single Source Composites Supplier



Best Technology Based Product Solutions

Polin Composites provides high-level service to many sectors, including **aviation, construction, automotive, hotel, urban equipment, and transportation**. Our experienced team proactively monitors the service we provide to the industry and our customers. To provide you with the best service, we work with many distinguished partners in the composite industry worldwide. We are the European leader in the field of composites with our R&D studies and the innovations we have brought to the sector.

World's First Fully Transparent Composite Waterslide



Polin Composites is a PolinGroup company.



Pools, Filters and Pool Equipments

Fipol Composite Pools produces top of the line pools, filters and pool equipment thanks to the years of experience of the group companies in the composites industry. With its **new, innovative production techniques**, Fipol is planning to bring a new approach to the industry, one that will introduce new fiberglass-based solutions to customer demands.



Motorboat Design and Manufacturing

As one of Europe's largest composite manufacturing companies, **Fipol Marine** is an expert in manufacturing specially designed motor yachts for true motor yacht enthusiasts, brings an **innovative approach to Motorboat Design and Manufacturing**.





Easy Installation High Surface

As a result of the partnership between Fipol Pool, one of the Polin Group companies, and Compass Europe, the leading composite pool manufacturer in Europe, **CEF Pool** was established to produce high-quality pools. Carbon ceramic pools produced by CEF Pool are installed in Europe by Polin Group and Compass Europe. These pools distinguish themselves from their competitors with their easy installation, high surface quality, and durability. Viewing customer satisfaction as a core aspect of its business, CEF Pool **offers the best possible solutions for its customers.**

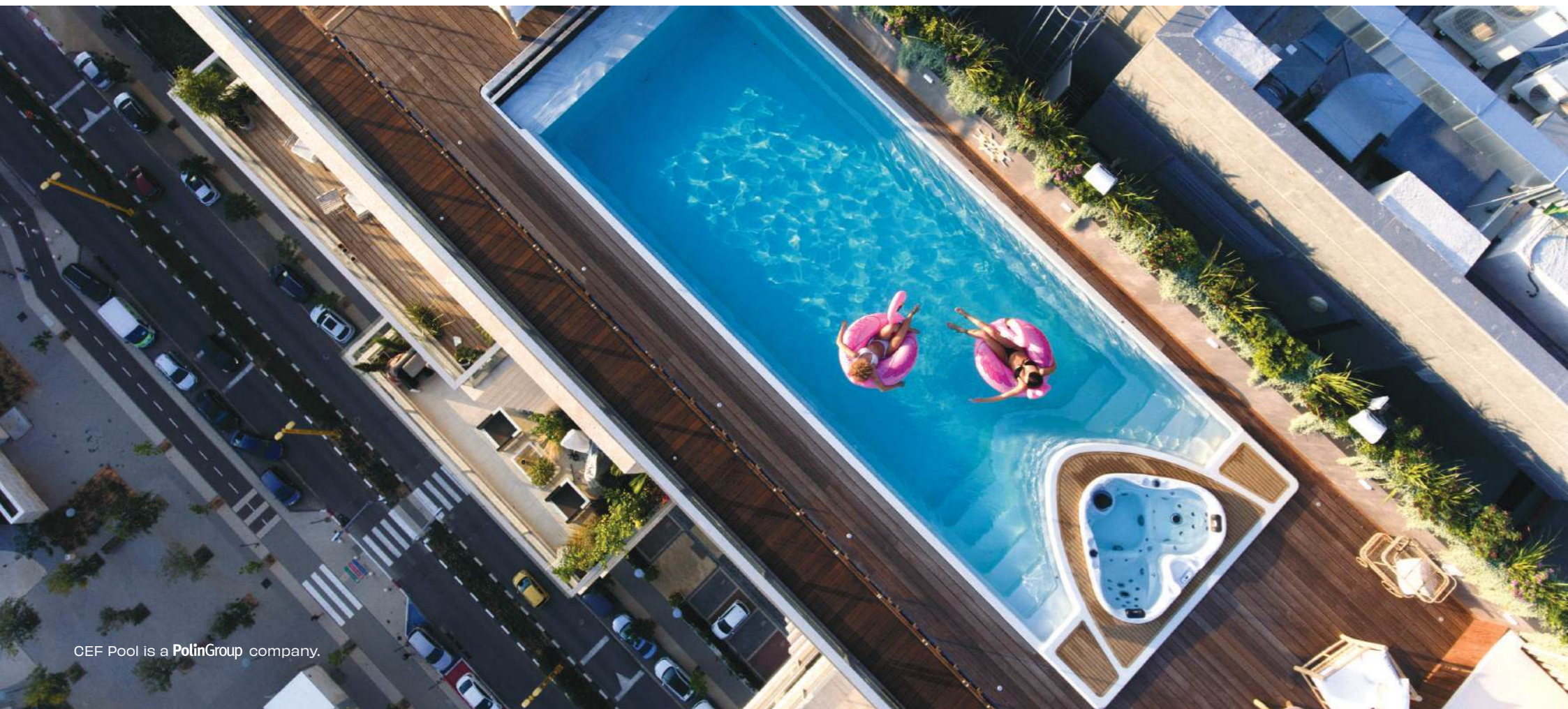

Wide Range of Custom Composites Product

Futura Form provides design, engineering, manufacturing, project management and after sales services with it is experienced, enthusiastic team. Thanks to its **high-tech skills and comprehensive knowledge about raw materials**, Futura Form is able to develop and produce a wide range of custom composite products.

By combining our experience with the team's design, engineering, and production skills, we have created unique venues, developed many projects and designed custom products for various industries, including the automotive, defense, transportation, and sanitary industries, to name several. Futura Form produces a wide range of products, using innovative technology and the highest quality materials available.

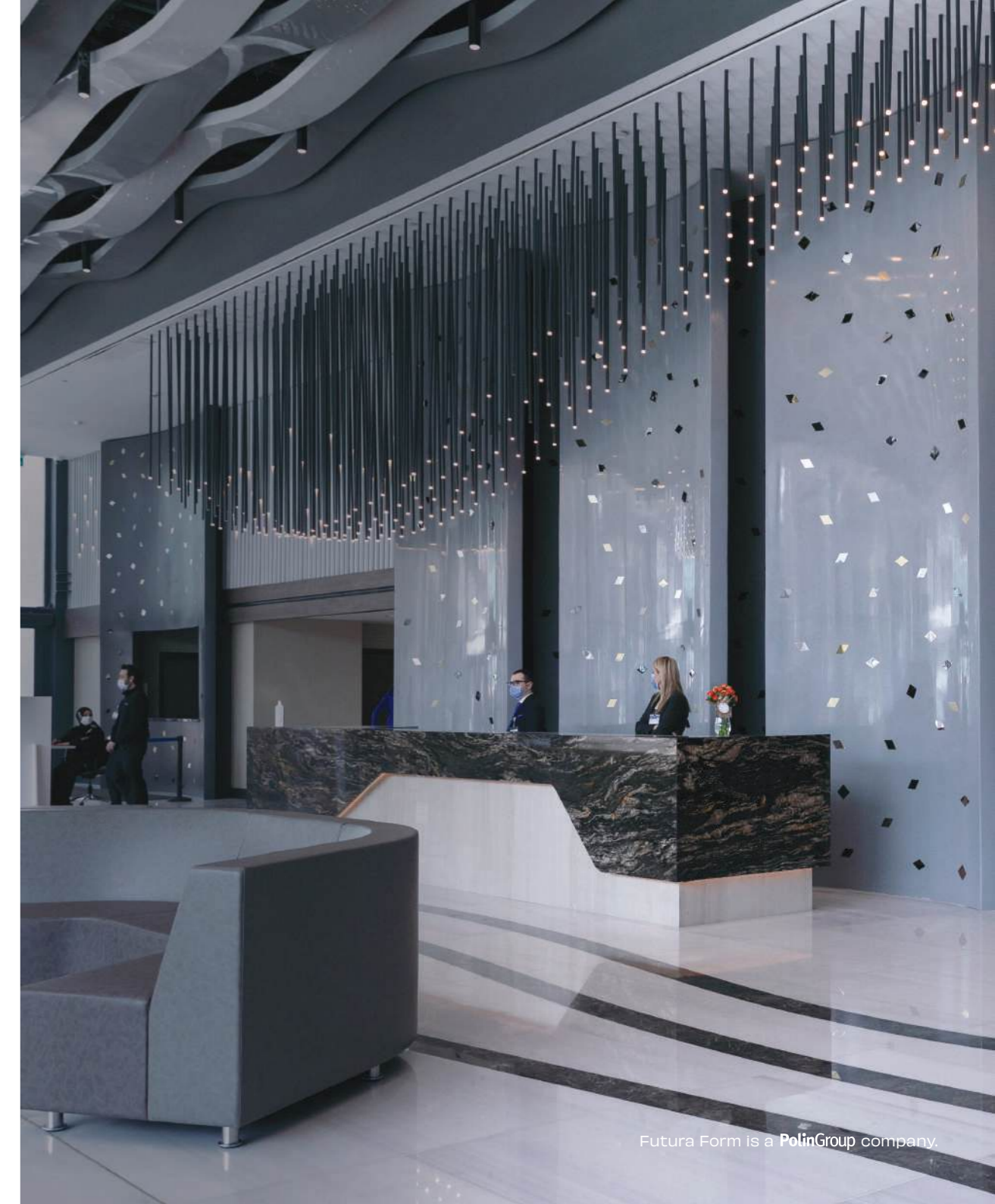



Single Source Amusement Supplier

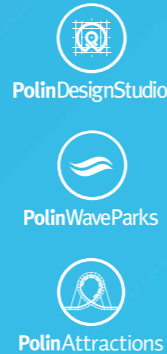

A to Z Solutions for Distinctive Design

Polin Design Studio designs the most sophisticated attractions, **working carefully with the unique characteristics of each project** to maximize the site potential and ensure success. Polin Design Studio has an experienced, talented and creative staff of professional architects and engineers dedicated to the amusement industry. With nearly half a century of experience, Polin Design Studio offers its customers expertise on the locations, topographies, climates, and capacities of all the parks it designs.

Polin Design Studio offers a wide range of services, including storytelling, master planning, concept design, schematic design, visitor flow studies, capacity calculations, architecture and structural features, landscape architecture design, conceptual attraction design, and art direction, to create unique venues.

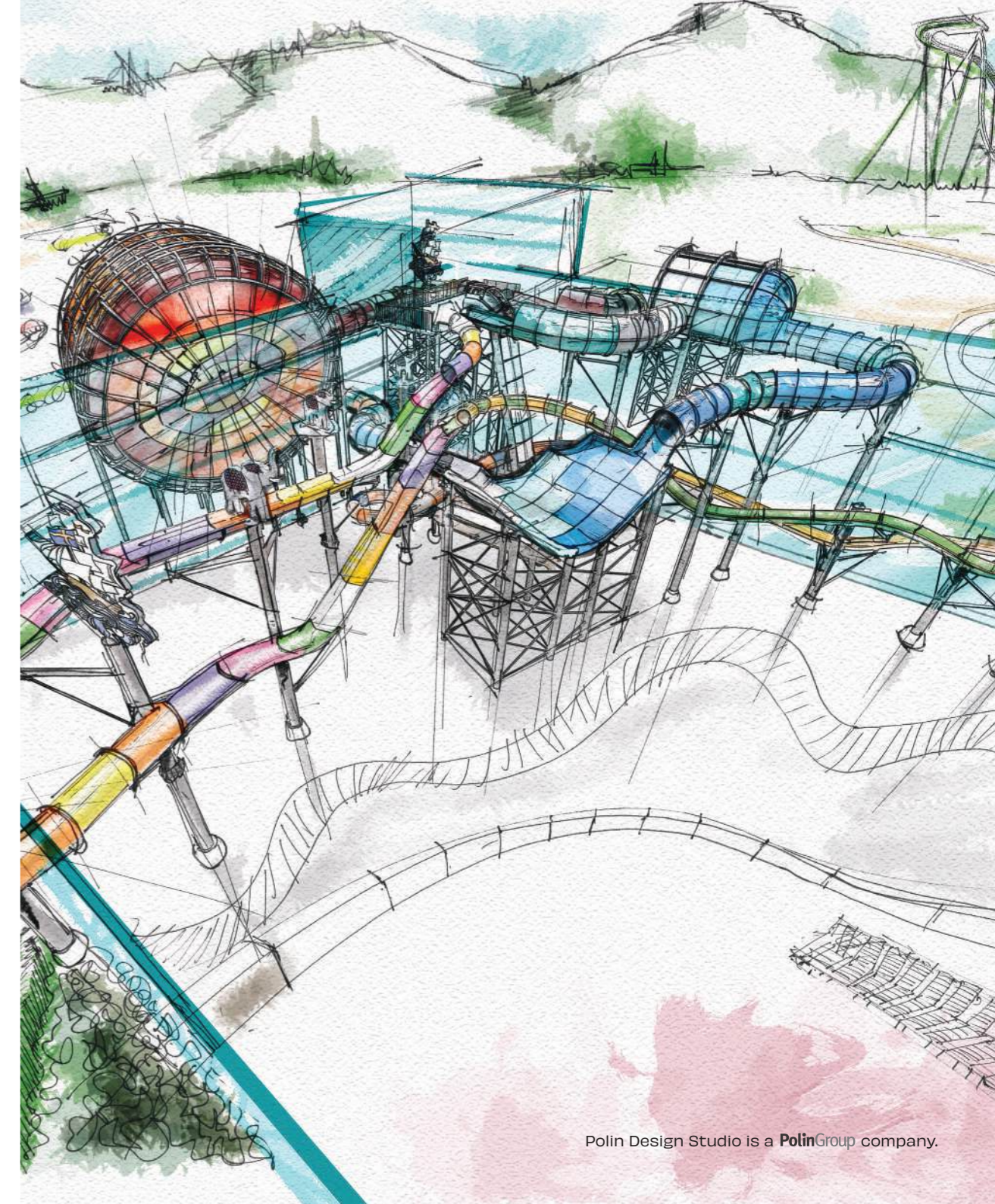



Design, Engineering, Manufacturing and Installation

Polin Waterparks is the world's leading waterpark supplier and signature waterslide designer. Polin Waterparks has completed **more than 4000 waterpark projects in 120 countries** around the world and is the biggest water slide supplier in Eurasia.

Polin Waterparks is a **PolinGroup** company.



New Dimension to Entertainment for Children of All Ages

Polin Spray Parks nurture kids' imaginations by providing them beautiful park spaces, filled with thematic elements and refreshing features, where they can engage in sporting activities and enjoy water play. Polin Spray Parks bring a new dimension to entertainment and a unique experience for children of all ages. The equipment for these parks is easy to assemble and does not require long construction times. At all Polin Spray Parks, **whether in amusement parks, hotels, school playgrounds or municipal parks**, you can rest assured that your children will be safe as they spend their time playing and learning in an environment with rich visuals and inventive designs.

Polin Spray Parks is a **PolinGroup** company.

From Concept Design to Realization

Futura Form knows how important it is to have unique venues that create immersive storytelling to keep a parks' atmosphere new, exciting, and first-rate so that visitors will keep coming back. With its limitless imagination and expertise in theming and architectural design, Futura Form **creates a land of fairytales inside cities and invites visitors to experience different worlds**, providing all services, from design and engineering to manufacturing, project management, and after-sales services, for amusement parks, architectural venues, and museums.

Futura Form develops and produces a wide range of custom products with its high-tech skills, comprehensive knowledge about raw materials, and extensive supply chain network. Over the last 10 years, Futura Form has also gained a strong reputation for providing turn-key solutions.

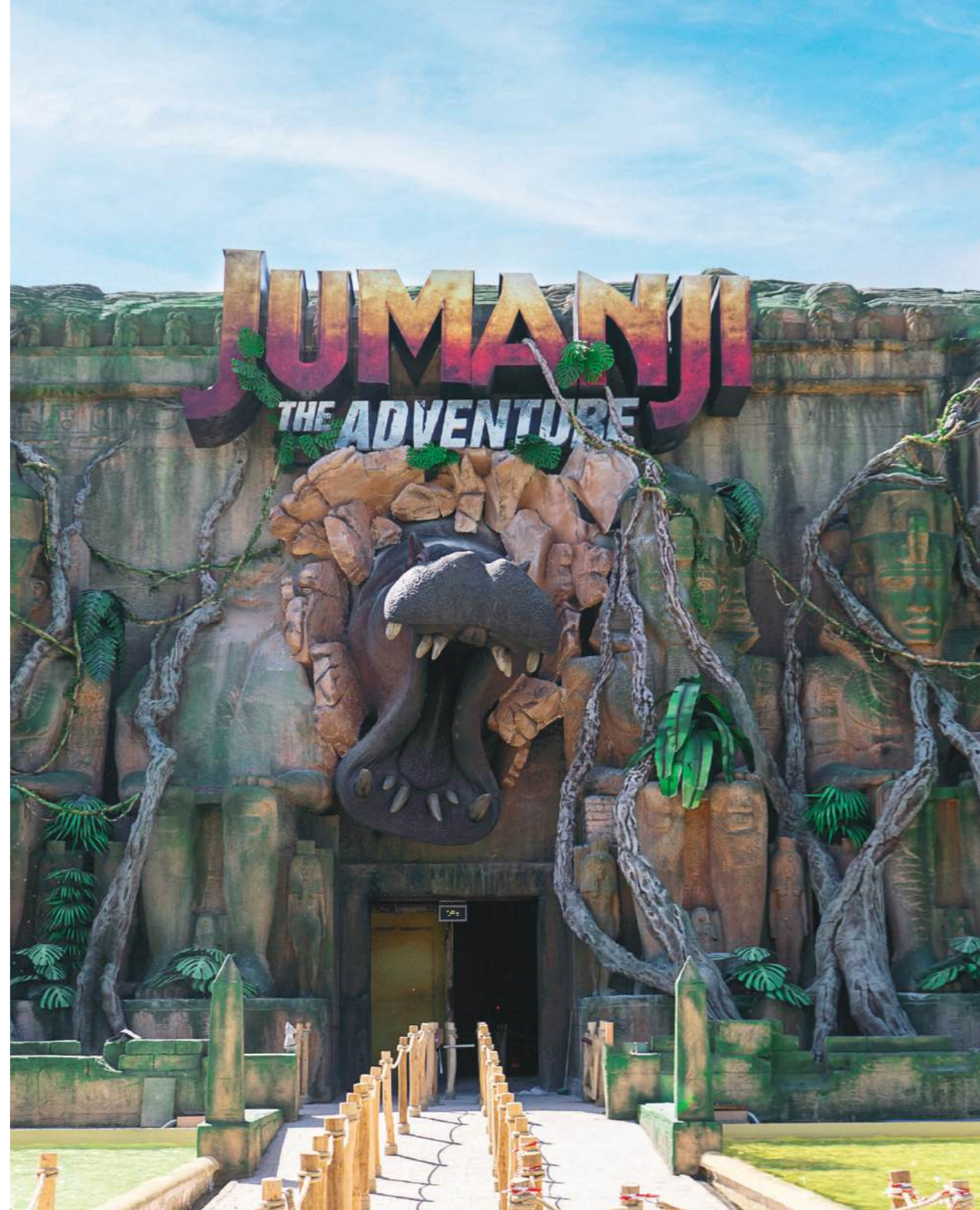

Technology, Gaming and Interactivity

Polin Game Technologies integrates technology, gaming and interactivity into waterpark attractions to deliver **new and unique guest experiences**. These features contribute to the creation of one-of-a-kind water attractions that are sure to bring high volumes of guests to waterparks. Polin Game Technologies focuses exclusively on creating new concepts and technologies by strategically combining the experience of our own highly skilled R&D engineers with those of other critical sectors-including some of the most well-known companies in their respective fields.

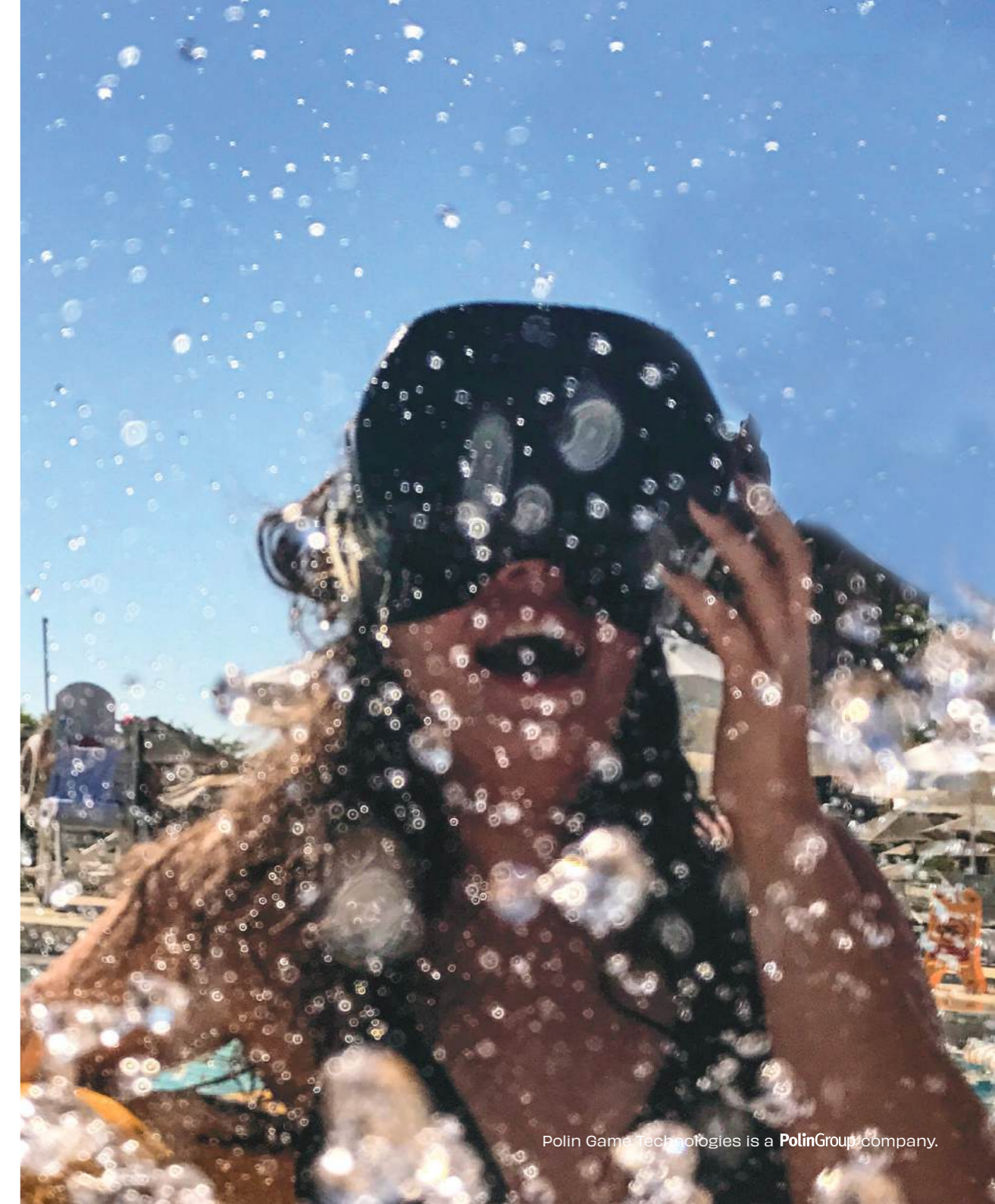



PolinWaveParks

Best-in Class Service, Constant Innovation and High-Quality Products

Polin Wave Parks generate waves that are sure to afford hours of fun and laughter for your guests. These parks are engineered for durability, **ease of operation, maintenance, safety and of course, fun.** Creating ideal conditions for wave parks in a safe and controlled environment at any time of the year, anywhere in the world comes easy for us thanks to Polin Wave Parks' ground-breaking technologies, innovative approaches and dedicated team of experts. The fact that most of our clients are repeat customers proves our commitment to providing them with best-in-class service, constant innovation and high-quality products.



PolinAttractions

Wet and Dry, Large or Small

Polin Attractions has the capacity to complete a wide range of attraction projects that fit the needs of amusement parks across the world. Using our advanced engineering skills and wealth of creativity, we offer **the industry's most innovative, intense and dynamic products**, wet and dry, large or small, to meet the desires and needs of every member of the family. From small rides to major amusement park projects, with our team approach, we ensure every project is completed on time. We use a multi-disciplinary approach that makes it possible to offer flexible solutions.





From Concept Design to Realization

Polin Park Services always deliver safe and fun experiences to your guests thanks to our team's extensive experience and expertise and our innovative maintenance strategies, waterslide repair, materials supply, parts replacement and slide resurfacing services. We passionately pursue excellence in these efforts and strive to deliver on our promises through great communication, continuous improvement and an intense focus on customer service. Our goal is simple: to create **fun, safe, thrilling, unforgettable experiences** for the guests of all our clients - experiences that rest on a bedrock of high-quality, reliable and safe attractions. With Polin Park Services and our authorized in-house team of professional technicians, who are charged with completing critical periodic maintenance and repair, you can rest assured that your attractions meet the highest standards of quality, reliability and safety.

Polin Park Services is a **PolinGroup** company.

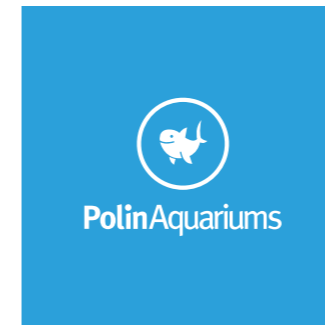

Design, Construction and Management

Polin Aquariums designs and builds public aquariums, managing the whole process, from the initial concept stage, the architecture and construction to the business plan, procurement of living creatures and development of brand identity. It aims to achieve excellence with its team of experienced architects, engineers, biologists, veterinarians and technical experts. The secret to the success of these attraction centers is the integrated setup that we have developed through experience.

Polin Aquariums is a **PolinGroup** company.



Single Source
Operator



Management and **Operation**

Funtastic Parks is an operating enterprise that has comprehensive knowledge of all the details of parks, from operations to marketing. If requested, Funtastic Parks can also be your solution partner for management and operation. With the Funtastic-brand franchising models we offer for aquariums, theme parks, water parks, resorts & cruises, and wild parks, we can provide turnkey installation solutions for your projects. **We also perform business management for you.**



Funtastic is a PolinGroup company.

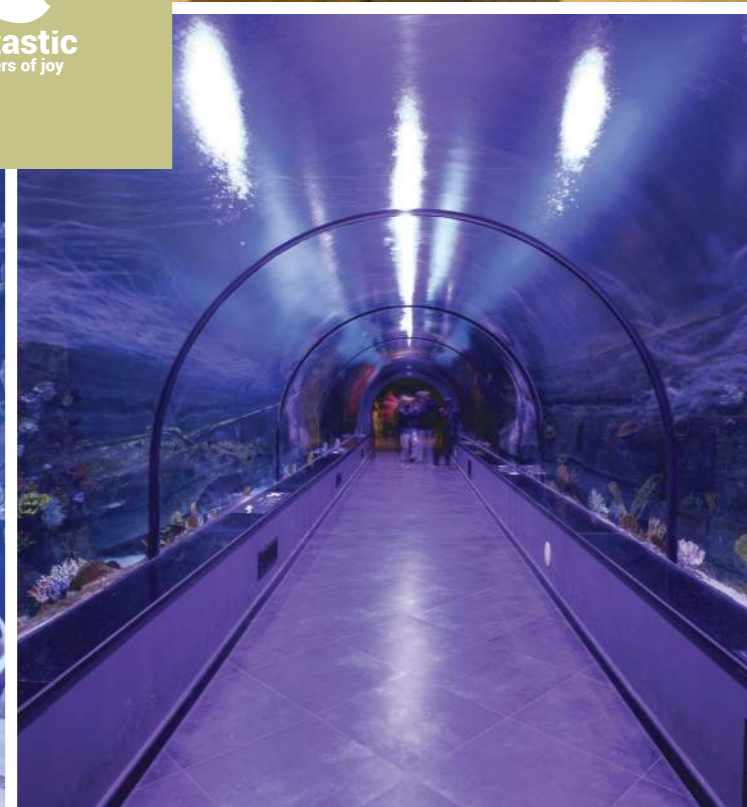

A to Z Solutions



ALL IN ONE & USER FRIENDLY PARK MANAGEMENT SOFTWARE

Experience the ease and quality of Polin with the Parcuero Park Management System, designed specifically for all amusement parks and theme parks. With Parcuero, enjoy comprehensive facility-specific detailed reports and exceptional customer relations, all conveniently under one roof.



Ticketing



Sales Point



Restaurant & POS Module



Prospect Management



Access Control Automation



Maintenance Management



Material Management & Purchasing



Membership Management



Event Management



Asset Management



Employee Management



IoT Integrations





Gebkim OSB, Refik Baydur 6, 41480 Dilovası, Kocaeli/TURKEY

T: +90 262 656 64 67 F: +90 262 656 64 75

polingroup.com.tr